

Hotel Pickup Call office to inform driver	International Pickup	Domestic Pickup	Hotel Pickup	International Pickup	Domestic Pickup
4.50 AM	6.50 AM	06.50 - 7.00 AM	2.10 PM	4.30 PM	17.50- 6.00 PM
5.30 AM	7.25 AM	7.25 - 7.35 AM	2.50 PM	5.10 PM	18.30 - 6.40 PM
6.10 AM	8.00 AM	8.00 - 8.10 AM	3.30 PM	5.50 PM	19.10 - 7.20 PM
6.50 AM	8.35 AM	8.35 - 8.45 AM	4.10 PM	6.30 PM	19.50 - 8.00 PM
7.30 AM	9.10 AM	9.10 - 9.20 AM	4.50 PM	7.10 PM	20.30 - 8.40 PM
8.10 AM	9.50 AM	9.50 -10.00 AM	5.30 PM	7.50 PM	21.10 - 9.20 PM
8.50 AM	10.30 AM	10.30-10.40 AM	6.10 PM	8.30 PM	21.50-10.00 PM
9.30 AM	11.10 AM	11.20- 11.20 AM	6.50 PM	9.10 PM	22.20-10.40 PM
10.10 AM	11.50 AM	11.50 - 12.00 PM	7.30 PM	Call office to remind driver	23.10-11.20 PM
10.50 AM	12.30 PM	13.10 - 1.20 PM	8.10 PM	9.50 PM	
11.30 AM	1.10 PM	13.50 - 2.00 PM	8.50 PM	10.30 PM	
12.10 PM	1.50 PM	14.30 - 2.40 PM		11.10 PM	
12.50 PM	2.30 PM	15.10 -3.20 PM			
1.30 PM	3.10 PM	15.50- 4.00 PM			
	3.50 PM	16.30 - 4.40 PM			
		17.10 - 5.20 PM			

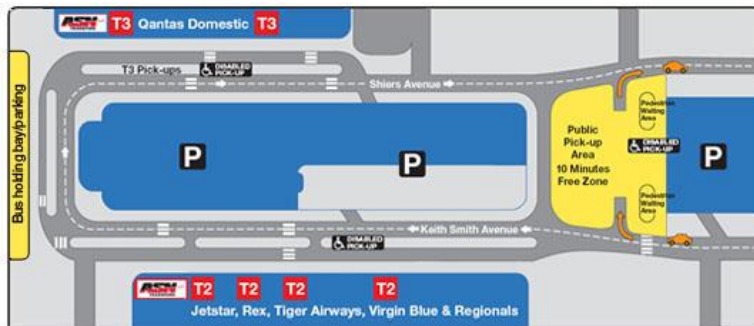

Bus pickup is located in between T2 and T3 at the Horseshoe bend in the road.
Bust Stop 4.

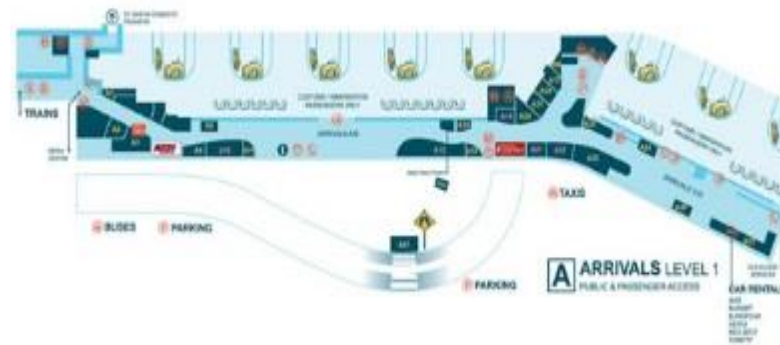

International (T1) walk out of the Terminal and turn right. The shuttle pick up from Bus Bay 12 opposite Rydges Hotel.